

Overall Stainless Steel Hand Dryer

USER MANUAL



- Do not install the device unless you are a qualified technician with appropriate technical approval. Installation by a unqualified person without knowledge of the applicable regulations may affect the safety and proper function of the device.
- Before using this appliance read all instructions carefully and all cautionary markings within this use manual, understand the principles of safety and proper use. Keep this user manual for future reference.

Contents

Contents,Features,Specifications	1
Important safety instructions	2
Parts description, dimensions	3
How to use	4
Cleaning & Maintenance	5
Troubleshooting, electrical wiring diagram	6
Safety precautions before installation	7
Mounting & Installation	8
Testing	9
Package contents	10

Features

- Hygienic way to dry hands, touchless operation.
- Saves energy costs, quickest way to dry hands.
- No need for the use of paper towels, reduction in costs, no need to empty waste bins.
- Overall AISI 304 stainless steel, no pollution,durable in use.
- Option to set automatic heating of air according to the surrounding temperature.
- To protect against overlong use of the device(randomly switched on by a fallen object, children playing, dirty trigger sensors etc.) A built in timer turns off the unit after 25 seconds.
To resume normal operation, remove hands or objects from the drying chamber of the hand dryer.
Insert hands again into the drying chamber and the device will start automatically.

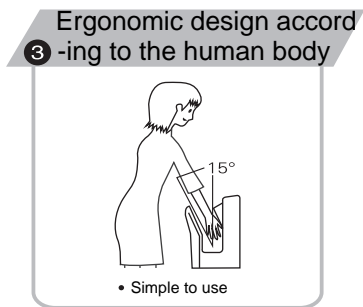
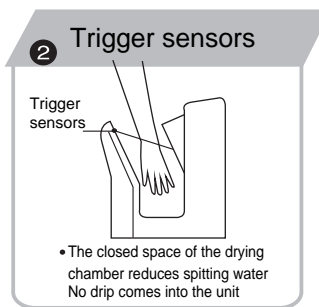
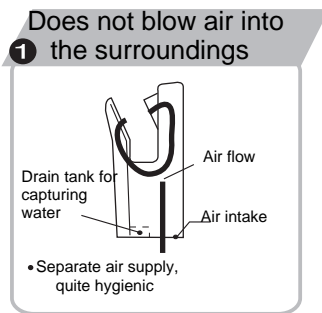

Specifications

Rated voltage	220VAC	Motor	Brushless DC motor
Input power	2200W	Induction method	IR blocking
Wind velocity	95m/s	Dimensions	290×220×625mm
Heating power	1500W	Net weight	12.5Kg
HEPA Class	U12	Heating start temperature	25 ± 2



Important safety instructions

Personal injury accidents will happen if use improperly



Prohibited

- Do not allow children to hang on the hand dryer. Risk of serious injury by fall.
Do not use the hand dryer under severe environment.



Do not use
in the shower
or bath

- Do not use in places where there is a risk water being sprayed directly onto the hand dryer.
Risk of serious injury by electric shock and unrepairable damage to the hand dryer.
- Do not use the hand dryer close to a bath, shower, in humid conditions or where there is high air humidity and water condensation (shower, saunas etc.).
Risk of serious injury by electric shock.



Do not
disassemble

- Do not disassemble or modify the hand dryer in anyway.
Risk of serious injury by electric shock, risk of fire or other type of injury to persons.
- The supplied power to the hand dryer must comply with the stated voltage and maximum current within this manual otherwise unrepairable damage may be done to the hand dryer.
- If the supply voltage fluctuates by more than 10%, this can damage hand dryer.
Supplying incorrect voltage can cause a fire, electrical shock and the hand dryer to malfunction.



Important!
Always follow
the instructions

- Always use a separate mains power socket. Do not connect multiple units into one mains socket, connecting multiple units may cause the power socket to overheat and cause a fire.
- When carrying out maintenance and servicing, always switch off the hand dryer and unplug the unit from the mains power supply to remove the risk of electric shock.
- Do not use the hand dryer without the drain tank and air filter. These must be installed at all times.
Wait at least 10 seconds before turning on the hand dryer after plugging the unit into the mains power supply.
- If the hand dryer is malfunctioning unplug it immediately from the mains power supply.
If necessary, turn off the circuit breaker. Call an authorised service to repair the hand dryer.



Grounding

- The hand dryer must be grounded on the power supply cable.
- Installation note: Do not install the hand dryer whilst it is plugged into the mains power socket.
- Wire connection should always be carried out by a qualified electrician.



Notice

- The hand dryer should not be used by children, persons with reduced physical, sensory or reasoning capabilities, or lack of experience and knowledge unless they have been given supervision or instruction concerning use of the unit by a person responsible for their safety.
- For increased safety, it is recommended to use circuit breaker to supply mains power to the hand dryer.
- It is forbidden to dispose of the hand dryer with domestic waste.
- If the mains power cord is damaged, it must be replaced by a qualified person or authorised service centre.
- Instructions how to dispose of the used packaging materials
- Do not allow children to play with the packaging materials. The hand dryer is wrapped in a plastic bag.
Danger of suffocation!
- Always dispose of used packaging materials. Recycle where facilities exist.



- Environmental Protection
Waste electrical products should not be disposed of with household waste.
Check with your Local Authority or retailer for recycling advice.

Parts description, dimensions

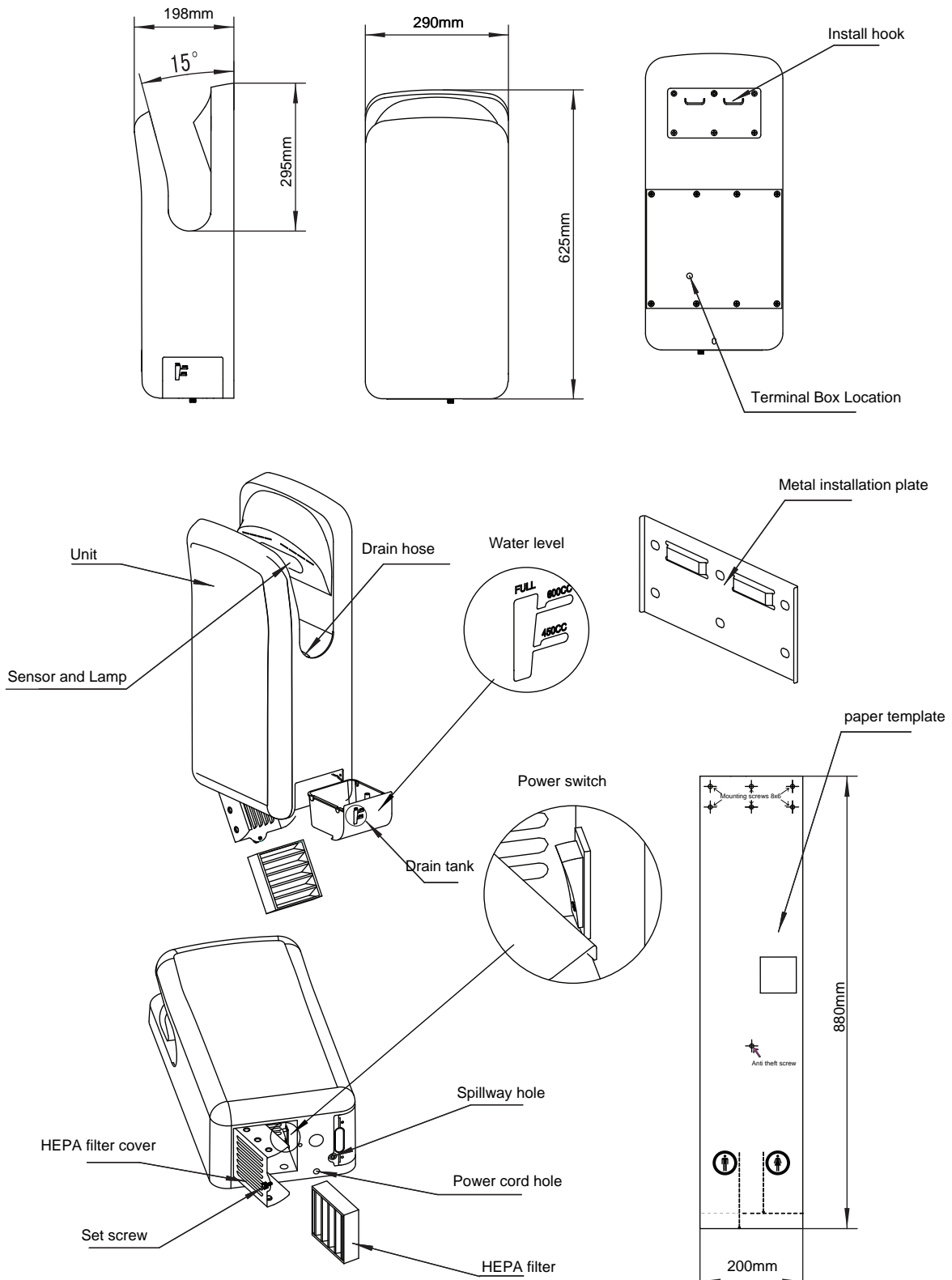

■ Using the hand dryer

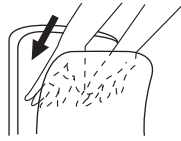

- Extend both arms with palms flat and insert into the drying chamber of the hand dryer.
The hand dryer will start automatically.



- Slowly move your hands up and down within the drying chamber allowing the air flow to wipe/dry your hands.

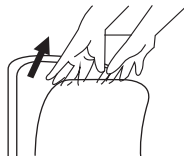

- When your hands are completely dry, remove them from the drying chamber of the hand dryer.
- The hand dryer will turn off automatically.

Sticker - How To Use

Jet hand dryer Drieds hands within seconds

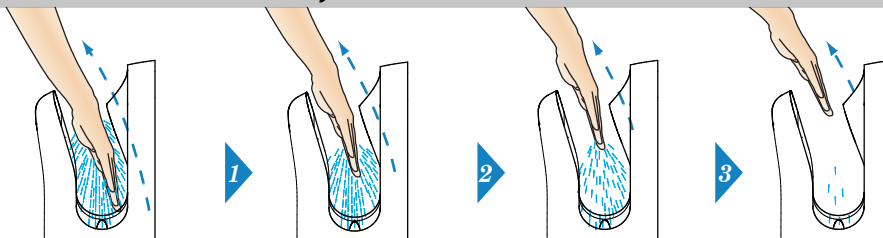

Place the How To Use sticker on a clearly visible place.
(Front panel of the hand dryer or on a wall near the dryer).

◆ When using the unit.

- Turn on the power switch.
- The lamp lights up.

Cleaning & Maintenance

With regular cleaning you will ensure continuous sterility and correct function of the hand dryer

- Clean the unit with a soft cloth.
If the unit gets very dirty, clean with a soft cloth dampened with neutral agent, then clean with a dry soft cloth.
- Remove the dirt from the sensor. (to prevent malfunction)



Note

- Only use the neutral cleaning agents.
- Do not use thinner, acidic or alkaline toilet cleaners, or nylon brush. (Otherwise, they may damage the smoothness of surface)
- Only use the alcohol to clean the hand-drying area. (Do not use alcohol anywhere else)
※Alcohol here means the alcohol used for disinfection (concentration below 75%).
- If the chemical cloths used, please read their instructions first.
- Disinfecting agents will damage your unit.



WARNING

- Before you clean the unit, turn off the power switch



Caution

- Wear gloves when cleaning.

Draining and Cleaning the drain tank

Before it fills up (at least once a week)

- The water blown off the hands is called “drain water” .
- Empty the drain water at any moment, in order to prevent accumulated water from exceeding the full level.
- It will start smelling if the accumulated water remains in the tank for too long time.

1

- Pull the drain tank out in the horizontal direction.
- This ensures the drain water does not s

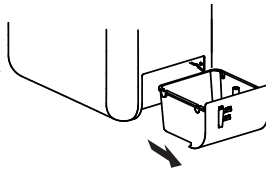

2

- Wash, clean and rinse the inside of the drain tank.
- Return the lid cover of the drain tank and slide the drain
- Tank back into the hand dryer

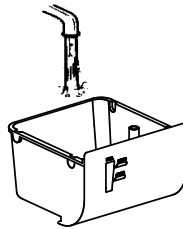

3

Add 200cc (around 1 cup) of water through the drain hole. (to prevent it from getting clogged)

- Use the unit after confirming that the water tank is in place.

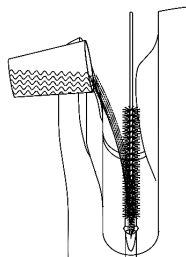

Cleaning the Unit body

- The unit is IP34.
- First washed the unit body, please keep the air inlet and outlet are sealed,
- Risk of serious injury by electric shock and unrepairable damage to the hand dryer, which would void the machine warranty.
- First washed the unit body, please remove the HEPA filter.

1

Remove the HEPA filter & drain tank.

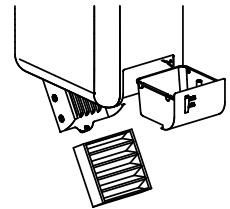

2

Seal the air inlet and outlet with better tape.

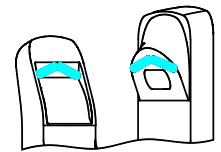

3

- Spray neutral detergent
- Clean the body with soft brush or cloth
- Rinse off thoroughly with clean water
- Dry the machine with dry towel or hair dryer
- Using the alcohol to clean the machine (concentration below 75%)

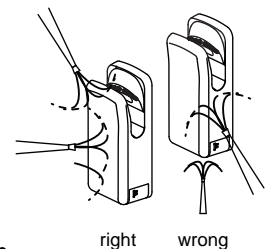

WARNING

- Forbid to wash from the bottom of machine (the HEPA filter location)

Cleaning & Maintenance

Cleaning the air filter

Around once a week

Filter maintenance

- Checking the air inlet on the bottom of machine regularly, keep it cleaning. Can wipe it with soft cloth.
- If HEPA filter should be change for new in some high-frequency environment, please contact with the seller.
- Please clean and replace filter according the use manual as below.



Caution

- Wear gloves when cleaning.
- The antibacterial coating is effective when the bacteria exposed the coated surfaces (See the shade areas on the figure)
- The antibacterial coating becomes not effective when the surfaces get very dirty.

1

Loosen the screw

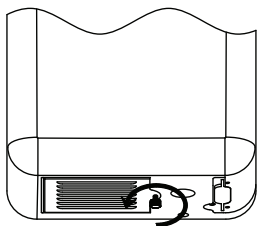

4

Beat it lightly by hand or use a vacuum cleaner.

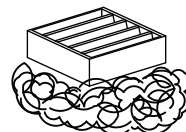

2

Hold the screw and pull down the HEPA filter cover, it will turn to left.

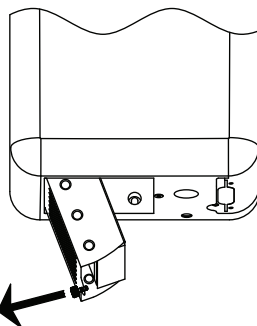

5

If the prefilter is very dirty, wash it off with cold or warm water, and dry it as much as possible.



3

Remove the HEPA filter and tear down the prefilter

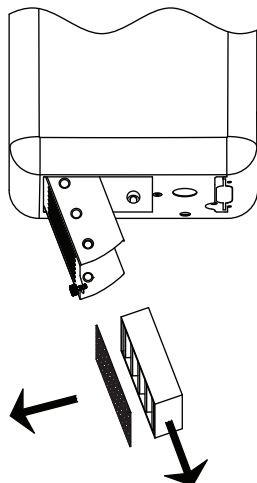

6

Replace the HEPA filter & prefilter
Tighten the screw



NOTE

- Please take good care of screw, in order to avoid the loss.

Troubleshooting, Electrical wiring diagram

If you discover the following circumstance, please inspection and handling as following:

Problem	Check	Action
No air blows even if hands are inserted	Do the display indicators lights up? Is the power switch on? Are you putting your hands all the way in?	<ul style="list-style-type: none"> • Turn the ground-fault circuit breaker on. • Turn the power switch on. • Put hands all the way in .
Machine works long time after hands drawn out, and the indicator lamp twinkle, the machine can start reconnecting power reconnecting power	<ul style="list-style-type: none"> • Any dirt or foreign body on sensor? 	<ul style="list-style-type: none"> • Switch off the power button, and then remove dirt or foreign body on sensor after the power light gone out. When finished, switch on power button.
No hot wind	<ul style="list-style-type: none"> • There is a Built-in heater in the unit. 	<ul style="list-style-type: none"> • Is the ambient temperature higher than 25 ± 2
Airflow is too low	<ul style="list-style-type: none"> • Is the speed button on low level? 	<ul style="list-style-type: none"> • Clean or change the filter

If the above actions do not work, turn off the power and the ground-fault circuit breaker, and call your dealer to inspect and repair it if necessary. (Costs are as per agreement with the dealer)

Electrical wiring diagram

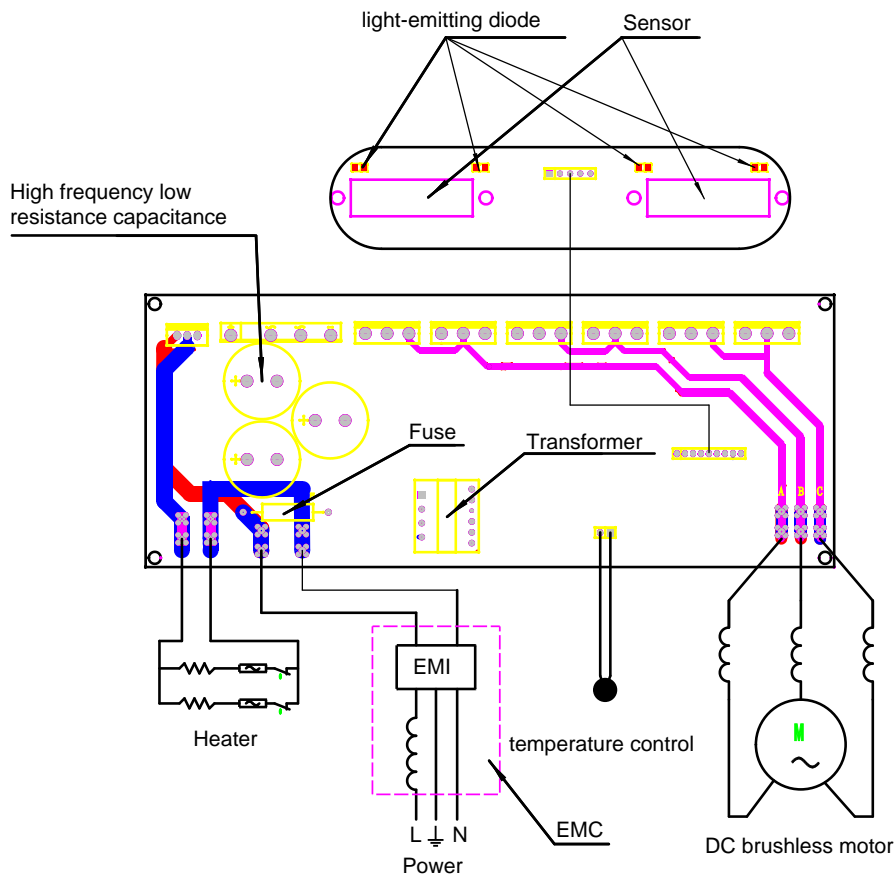

Safety precautions before installation

▲ Installation note:

- Do not install the hand dryer whilst it is plugged into the mains power socket. Install the hand dryer in a enough strength place, risk of serious injury by fall.
- Always wear rubber gloves when installing.

■ Do not install in the following types of location otherwise this may cause malfunction

- Locations where the temperature can exceed -10°C or 40°C .
- Locations where the unit may come into direct contact with water.
- Locations where the unit is under direct or strong sunlight
- Locations where there is a lot of condensation.
- Locations where corrosive, neutral, or reductive gases are present.
- Places lower than -20m or higher than 2000m above sea level

■ Installation location

- Install somewhere the unit will be easy to use, as shown in the figure. If the unit is installed too low, water may get on it when the floor is being cleaned. (The bottom of the unit must be at least 150 mm higher than the floor or any object)
- Ensure there are no mirrors or walls near the right side, as drops of water may splatter to the right when drying hands. (Recommended distance is at least 100 mm .)
- Avoid locations where people or doors might bump into the unit.
- Choose a completely flat surface on the wall to install the unit.

■ Installation base

- Clean the place where installing the hand dryer.
- Read carefully the information in the paper template.
- Place the paper template onto the wall and mark the position of the installation screws and mouting screws.
- Attach the metal mounting plate to the wall using the 6 supplied mounting screws. Drill the $\text{dia.}8\text{mm}$, and 40mm deep holes.

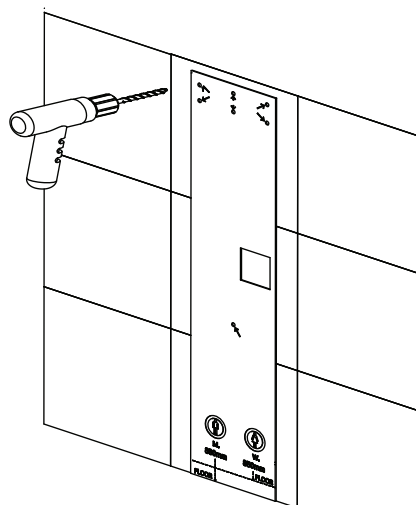
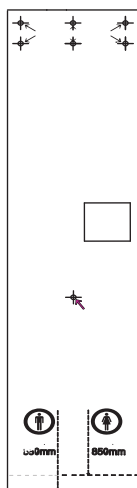

Mounting & Installation

- Use a single-phase alternating rated voltage supply.(Do not be used with a power supply exceeding rated voltage $\pm 10\%$.)
- Use a power cord which is between $1.5\text{mm}^2\text{--}2.0\text{mm}^2$ thick. (Cords other than $1.5\text{mm}^2\text{--}2.0\text{mm}^2$ single-core cords cannot be used.)
(A drop in voltage is possible if the power cord exceeds 5 m in length, so we recommend using a 2 mm^2 cord.)

1

Wire the unit.

Embed the switchbox in the installation location (1 switchbox no cover) and wire the power cord (with the green and yellow combined is ground line).

- If no switchbox is used, the power cord will be pushed out, and prevent the unit from being installed firmly against the wall.

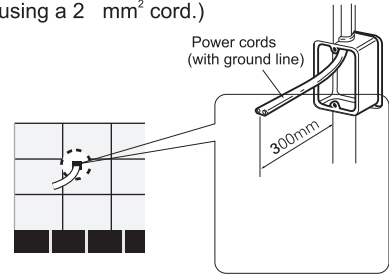

2

- Attach the installation panel to the wall using the 6 installation screws and 1 anti theft screw.
- If the wall is concrete, use commercially available metal screw plugs(curl plugs,etc.).
- If the wall is not concrete, reinforce is before installation.

NOTE

- The bottom one is anti theft screw, please do not install the set screw.

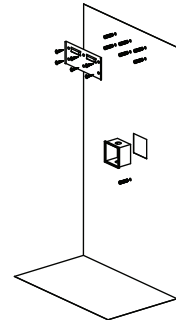

3

- Put the machine on the tabel, with back side of the machine facing you. Remove the 8 screws, open the back cover.

NOTE

- The machine must be put on the soft cloth, to avoid scratches in machine.

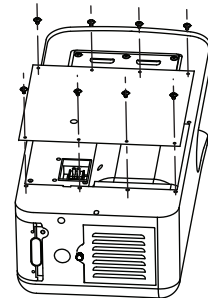

4

Pull the separate line power cord into the unit and secure inside. (This machine has been with power cord. if you want to change, please according to the following steps.)

- 1.Pull the power cord through the power cord hole on the rear of the machine.
- 2.Connect the power cord with the terminal box. The brown color line connect L, and blue color line connect N. yellow-green is the grounding wire.
- 3.Tighten the lines with splint.
- 4.Return the back cover to its position.
- 5.Tighten the lines with wire ring and pile in the power cord hole.

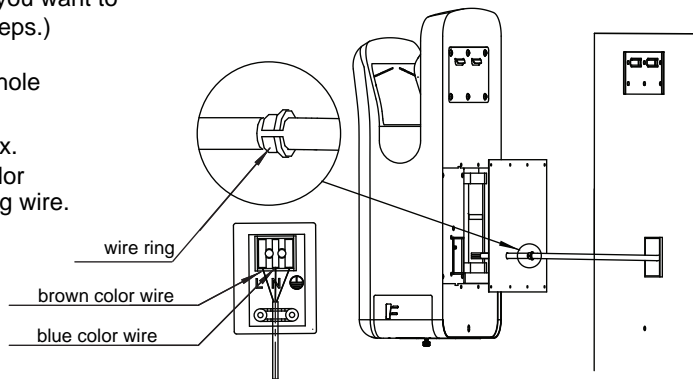

Mounting & Installation , Test

5

1. Move the hand dryer near the wall, put the power cord into the switchbox.
2. After the mounting plate has been securely fastened to the wall, hang the hand dryer onto the wall mounting plate according to the diagram.

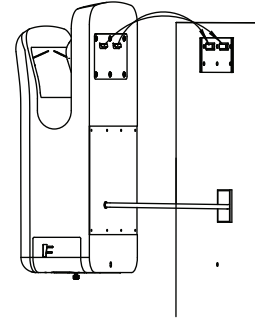

6

1. Open the filter metal cover see section "Filter maintenance" in this user manual on page 6.
2. Fastening machine when tighten the anti theft screw.
3. Switch shall be in the ON position
4. Return the drain tank back to its position checking if it is properly in its place.

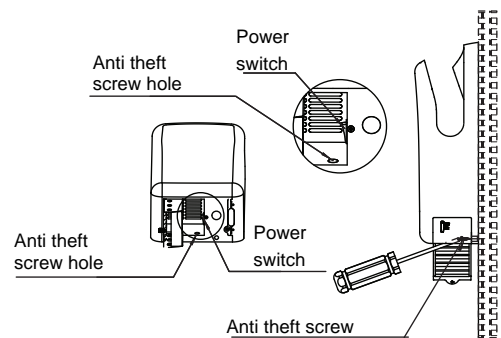

Test Run

	Step	Check	Result
1	Check the voltage of power supply	Please use the rated voltage?	
2	Turn the ground-fault circuit breaker on		
3	Turn the power switch on	Does the power indicator light up?	
4	Dry hands	Is the air blowing?	
5	Check the unit	Is the unit installed firmly? Any vibration or strange noise?	

* Do not turn the unit power switch on with your hands inside.

* If the self-check indicator in the display lights or is flashing, turn off the power switch off, and turn the power back on when all the indicators go off (after 40 seconds).

Package contents

Hand dryer-----	1pc
Metal mounting plate-----	1pc
Paper template-----	1pc
8mm wall plug-----	7pcs
5x35 mm self-tapping screw-----	7pcs
How to use stick-----	1pc
User manual-----	1pc